



# BALCONI EXTRUSION PRESSES





# BALCONI EXTRUSION PRESSES

TECHNICAL SPECIFICATIONS	KE 100-200	KE 100-300	KE 150-350	KE 200-360	KE 250-350	KE 250-375	KE 315-375	KE 400-400
Force kN	1000	1000	1500	2000	2500	2500	3150	4000
Strokes per minute no.	100-260	100-240	100-220	100-210	100-220	75-200	75-180	80-160
Ram stroke mm	200	300	350	360	350	375	375	400
Ram adjustment mm	12	12	12	12	12	15	15	15
Max tube/can Ø mm	30	30	45	50	53	53	59	66
Max tube/can length mm	135	200	240	240	240	250	250	280

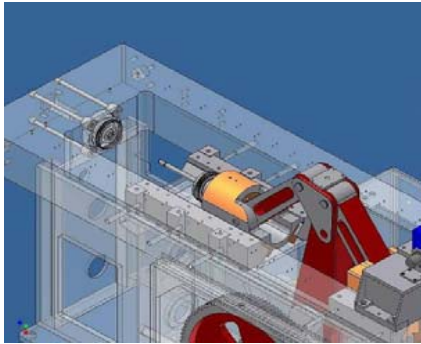

*Double knuckle-joint:  
30% impact speed reduction*

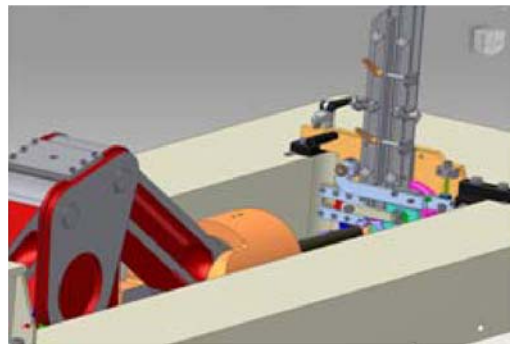

*Hydraulic quick tool clamping system  
to reduce set up time*

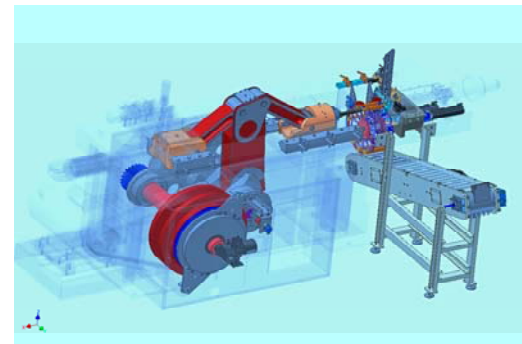

*Loading and unloading system*

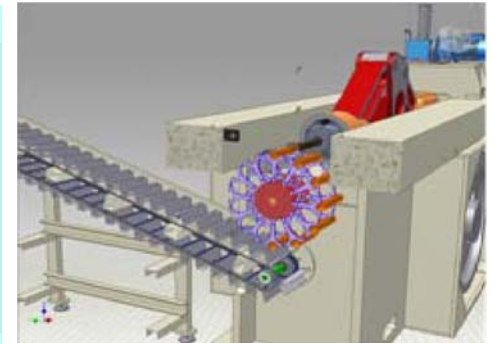

*Can take-off unit*



BALCONI PRESSECCENTRICHE S.p.A.  
Via Circonvallazione 195  
20814 VAREDO – ITALY  
Tel. +39 0362 5361 [www.balconi.it](http://www.balconi.it)  
[commerciale@balconi.it](mailto:commerciale@balconi.it)

